

SLIP-ON PROFILES

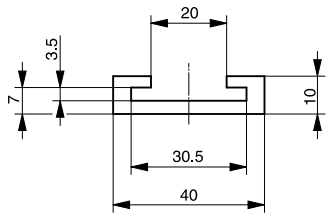

Here is a small selection of our extensive range of profiles.
View our complete range at www.murtefeldt.com.

Plastic C profile for flat steel, 30 × 3 milled/extruded



Plastic C profile for flat steel, 40 × 8 milled

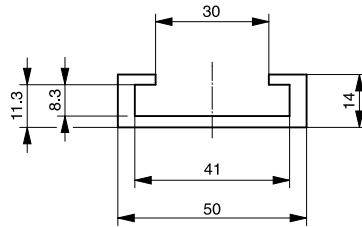

Plastic C profile for flat steel, 40 × 8 extruded

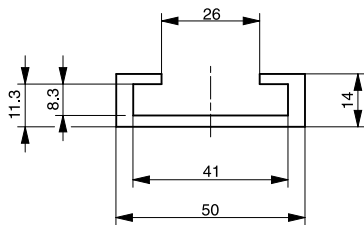

Plastic C profile for flat steel, 40 × 10 milled

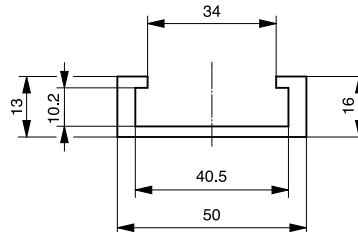

Plastic C profile for flat steel, 40 × 10 extruded

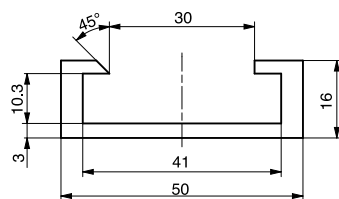

Plastic C profile for flat steel, 50 × 6 milled

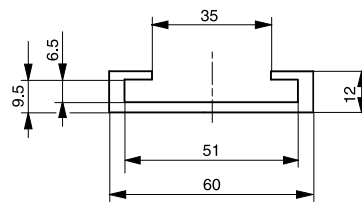

Plastic C profile for flat steel, 50 × 6 extruded

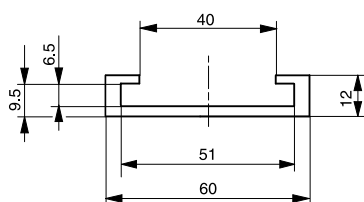

Plastic L profile for flat steel, 40 × 8 milled

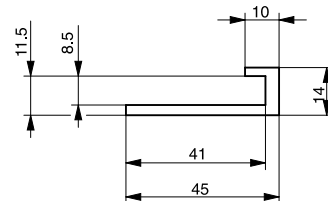

* For milled profiles. Tolerances as per DIN 16941 for extruded profiles.